

Appendix E

Site Plans

Harrington McAvan Ltd.



EXISTING FEATURES NOTES

GENERAL SITE PLAN INFORMATION

- THIS SITE PLAN CONSISTS OF 4 DRAWINGS AND MUST BE READ COLLECTIVELY.
- ALL MEASUREMENTS SHOWN ON THIS SITE PLAN ARE IN METRES.

LICENCE INFORMATION

- THIS SITE PLAN IS PREPARED FOR SUBMISSION TO THE MINISTRY OF NATURAL RESOURCES UNDER THE AGGREGATE RESOURCES ACT FOR A CLASS 'A' LICENCE, PIT BELOW THE WATER TABLE.
- APPLICANT:
PATON AGGREGATES & SOILS LTD.
344028 EBENEZER ROAD,
MOUNT ELGIN, ONTARIO
N0J 1N0

- TOTAL AREA TO BE LICENCED: 11.0 ha
TOTAL AREA TO BE EXTRACTED: 9.4 ha
TOTAL AREA TO REHABILITATED: 9.4 ha

BASE INFORMATION

- TOPOGRAPHIC INFORMATION FOR LOT 17, CONCESSION 2 NTR WAS OBTAINED FROM FIRST BASE SOLUTIONS, DECEMBER 13, 2024. ALL ELEVATIONS ARE GEODETIC AND ABOVE SEA LEVEL (A.S.L.).
- THE SITE WAS FIELD CHECKED BY HARRINGTON MCAVAN LTD., OCTOBER 29, 2024.
- ZONING INFORMATION OBTAINED FROM MAPS MIDDLESEX.CA, DECEMBER 19, 2024. PROPOSED LICENCE AREA IS PRESENTLY ZONED A (AGRICULTURE). A ZBA WILL BE APPLIED FOR TO CHANGE A TO M3 (EXTRACTIVE INDUSTRIAL).
- UTRCA REGULATION LIMIT OBTAINED FROM UPPER THAMES RIVER CONSERVATION AUTHORITY REGULATED AREA SCREENING MAP, DECEMBER 19, 2024.

HYDROGEOLOGICAL INFORMATION

- HYDROGEOLOGICAL INFORMATION INCLUDING GROUNDWATER ELEVATION WAS OBTAINED FROM REPORT BY GROUNDWATER SCIENCE CORP. DATED MARCH 2026.
- THE MAXIMUM PREDICTED WATER TABLE ELEVATION VARIES ACROSS THE SITE FROM 282.2 TO 283.4 m ABOVE SEA LEVEL (A.S.L.).
- THE SITE IS LOCATED IN THE UPPER THAMES RIVER SOURCE WATER PROTECTION AREA. SOURCE WATER PROTECTION POLICIES DO NOT APPLY TO THIS SITE (REFER TO HYDROGEOLOGICAL REPORT).

TECHNICAL REPORTS

- HYDROGEOLOGICAL INFORMATION WAS OBTAINED FROM REPORT BY GROUNDWATER SCIENCE CORP. DATED MARCH 2026 (REFER TO SHEET 2 OF 4 FOR TECHNICAL RECOMMENDATIONS).
- NATURAL ENVIRONMENT INFORMATION WAS OBTAINED FROM REPORT BY TERRASTORY ENVIRONMENTAL CONSULTING DATED MARCH 2026 (REFER TO SHEET 2 OF 4 FOR TECHNICAL RECOMMENDATIONS).
- ARCHAEOLOGICAL INFORMATION WAS OBTAINED FROM REPORT BY TIMMINS MARTELLE HERIAGE CONSULTANTS INC. DATED FEBRUARY 18, 2025 (REFER TO SHEET 2 OF 4 FOR TECHNICAL RECOMMENDATIONS).

LEGEND

	BOUNDARY OF LICENCED AREA		120m INFORMATION BOUNDARY
	EXISTING LICENCED AREA		LOT LINE
	UTRCA REGULATION LIMIT		WATERCOURSE
	EXISTING FENCE		EXISTING BUILDING
	EXISTING 6m CONTOUR LINE		EXISTING HYDRO POLE
	EXISTING 1m CONTOUR LINE		DIRECTION OF SURFACE WATER DRAINAGE
	EXISTING SPOT ELEVATION		TEST PIT LOCATION AND NUMBER (DUG BY APPLICANT ON OCTOBER 29, 2024)
	EXISTING TREE COVER		MONITORING WELL LOCATION AND NUMBER INSTALLED UNDER THE DIRECTION OF GROUNDWATER SCIENCE CORP. NOVEMBER 2024
	EXISTING WETLAND		EXISTING FIELD ACCESS (NO GATE)
	EXISTING PIT FACE		
	EXISTING BERM		
	EXISTING SILT FENCE		
	EXISTING MARKER POST		
	LOCATION OF SECTION		

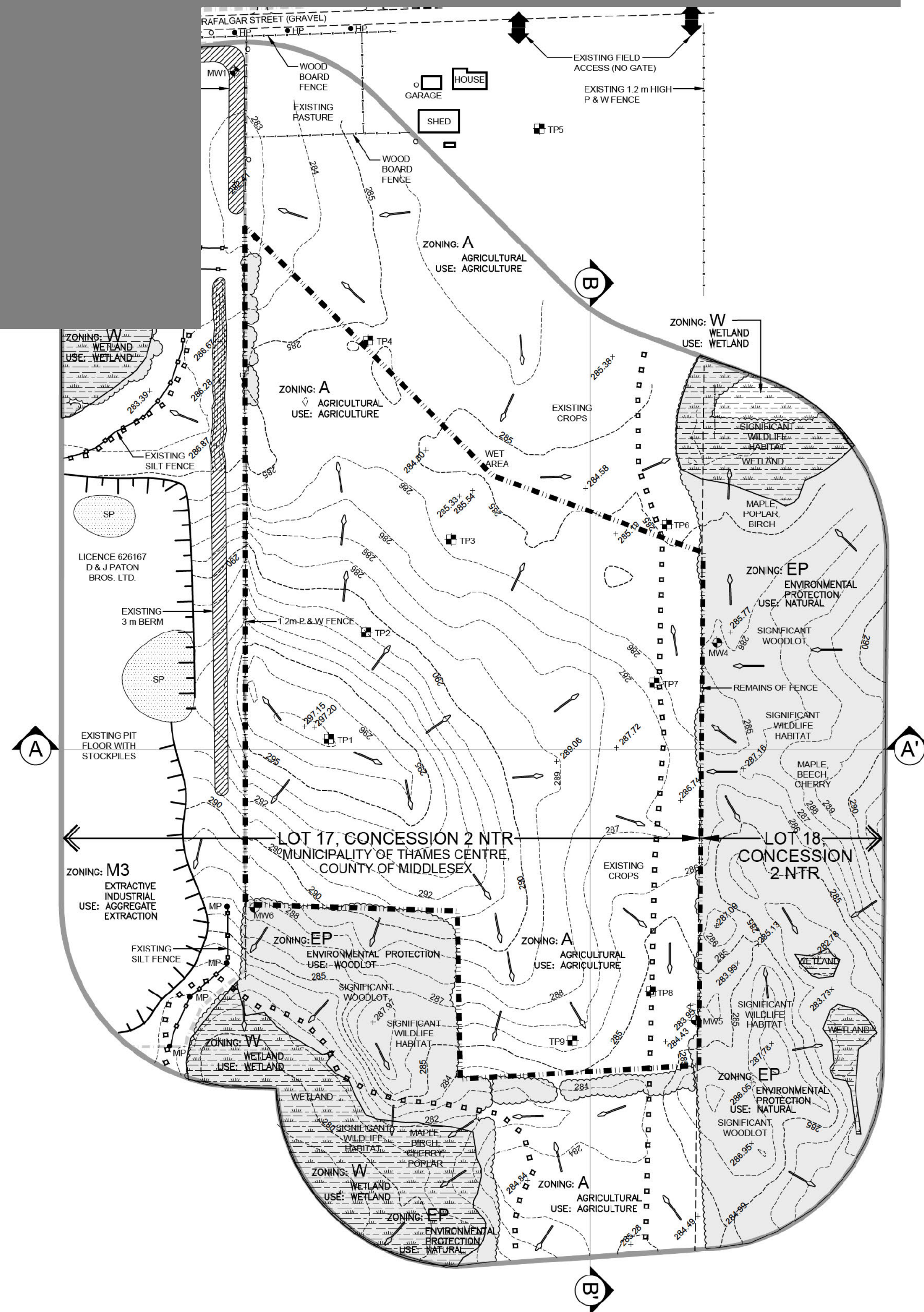

KEY MAP

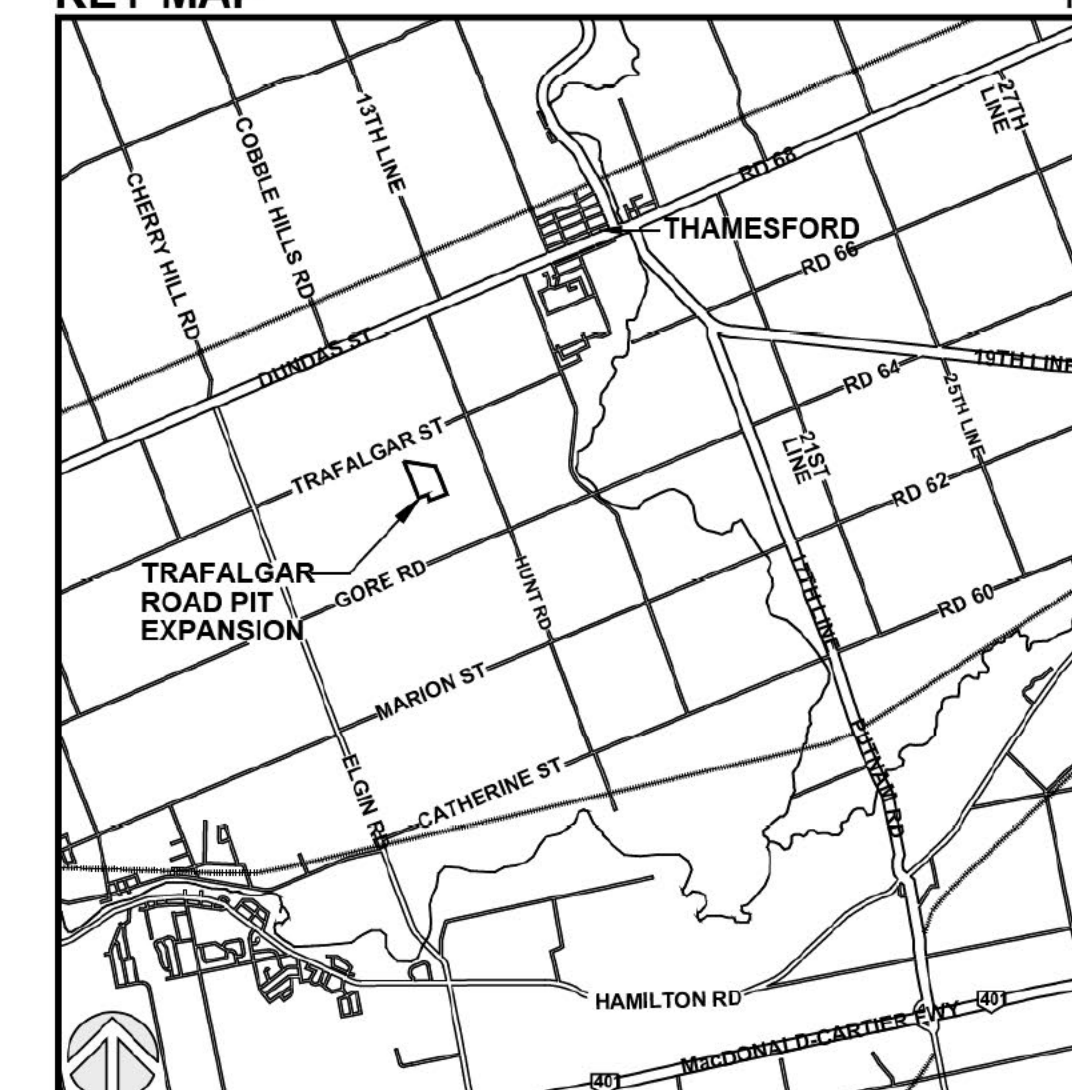

NO.	DATE	REVISIONS	OWNER	HW	UNR

Pre Licence Review Site Plan Amendments

Harrington
McAvan Ltd

6882 14th Avenue
Markham, Ontario L6B 1A8
Tel: 905-294-8282 Fax: 905-294-7023
www.harringtonmccavan.com
Offices in Markham & Cambridge

Project Name

PATON AGGREGATES & SOILS LTD.

TRAFALGAR EXPANSION PIT

LICENCE No:
LICENCEE SIGNATURE [REDACTED]
PART LOT 17, CONCESSION 2 NTR
MUNICIPALITY OF THAMES CENTRE (FORMERLY NORTH DORCHESTER), COUNTY OF MIDDLESEX

Scale 1: 2000	North	Stamp
Drawing Status FOR LICENCE APPROVAL		
Drawn SB	Checked RM/BJ	Issue Date MAR 2026
Drawing Title EXISTING FEATURES PLAN		Project Number 24-22
		Drawing Number 1 OF 4

TECHNICAL RECOMMENDATIONS

THE FOLLOWING ARE THE TECHNICAL RECOMMENDATIONS FROM ALL OF THE EXPERTS' REPORTS AS OF FEBRUARY 2026.

ARCHAEOLOGICAL ASSESSMENT - TMHC - FEBRUARY 18, 2025
 SHOULD PREVIOUSLY UNDOCUMENTED ARCHAEOLOGICAL RESOURCES BE DISCOVERED, THEY MAY BE A NEW ARCHAEOLOGICAL SITE AND THEREFORE SUBJECT TO SECTION 48(1) OF THE ONTARIO HERITAGE ACT. THE PROPONENT OR PERSON DISCOVERING THE ARCHAEOLOGICAL RESOURCES MUST CEASE ALL HERITAGE OF THE SITE IMMEDIATELY AND ENGAGE A LICENSED CONSULTANT ARCHAEOLOGIST TO CARRY OUT ARCHAEOLOGICAL FIELDWORK, IN COMPLIANCE WITH SECTION 48(1) OF THE ONTARIO HERITAGE ACT.

THE CEMETERIES ACT, R.S.O. 1990, C. 4 AND THE FUNERAL, BURIAL AND CREMATION SERVICES ACT, 2002, S.O. 2002, C. 33 (WHEN PROCLAIMED IN FORCE) REQUIRE THAT ANY PERSON DISCOVERING HUMAN REMAINS MUST NOTIFY THE POLICE OR CORONER AND THE REGISTRAR OF CEMETERIES AT THE MINISTRY OF CONSUMER SERVICES.

NATURAL ENVIRONMENT ASSESSMENT - TERRASTORY ENVIRONMENTAL CONSULTING INC. - MARCH 2026

- PROVINCIAL SIGNIFICANT WETLANDS**
- ACTIVITIES AND OTHER DISTURBANCES ASSOCIATED WITH PIT OPERATIONS ARE PROHIBITED WITHIN 30 m OF THE SIGNIFICANT WETLAND.
 - ANY NECESSARY LIGHTING TO SUPPORT PIT OPERATIONS WILL BE DIRECTED AWAY FROM THE SIGNIFICANT WETLAND (I.E., NORTHWARD) TO THE EXTENT PRACTICABLE.
- SIGNIFICANT WOODLANDS**
- ACTIVITIES AND OTHER DISTURBANCES ASSOCIATED WITH PIT OPERATIONS ARE PROHIBITED WITHIN 15 m OF THE DRIPLINES OF THE SIGNIFICANT WOODLANDS.
 - THE 15 m SETBACKS FROM THE DRIPLINES OF THE SIGNIFICANT WOODLANDS WILL BE WELL-MARKED (I.E., STAKED) UNDER THE DIRECTION OF A QUALIFIED ECOLOGIST.
 - THE 15 m SETBACKS FROM THE DRIPLINES OF THE SIGNIFICANT WOODLANDS WILL REMAIN IN OR BECOME NATURAL, SELF-SUSTAINING VEGETATION.
 - THE 15 m SETBACKS FROM THE DRIPLINE OF THE SIGNIFICANT WOODLANDS WILL ACT AS A BUFFER ENHANCEMENT AREA AND BE SUBJECT TO NATIVE PLANTINGS CONSISTING OF A VARIETY OF TREES AND SHRUBS.
 - ANY NECESSARY LIGHTING TO SUPPORT PIT OPERATIONS WILL BE DIRECTED AWAY FROM THE SIGNIFICANT WOODLANDS TO THE EXTENT PRACTICABLE.
- SIGNIFICANT WILDLIFE HABITAT**
- SHOULD ANY TERRESTRIAL CRAWFISH OR ASSOCIATED CHIMNEYS BE IDENTIFIED WITHIN 30 m OF ANY PIT OPERATIONS, OR OTHERWISE IN AN AREA THAT COULD BE IMPACTED BY PIT OPERATIONS, THEY WILL BE SAFELY RELOCATED TO APPROPRIATE HABITAT IN ACCORDANCE WITH A TERRESTRIAL CRAWFISH RELOCATION PLAN.
 - AN AMPHIBIAN MOVEMENT CORRIDOR WILL BE ESTABLISHED ALONG THE NORTHERN BOUNDARY OF THE SITE TO CONSIST OF NATURAL, SELF-SUSTAINING VEGETATION.
 - EXTRACTIVE USES AND OTHER DISTURBANCES ASSOCIATED WITH PIT OPERATIONS ARE PROHIBITED WITHIN THE AMPHIBIAN MOVEMENT CORRIDOR.
 - THE AMPHIBIAN MOVEMENT CORRIDOR IS TO BE SEEDED WITH THE ONTARIO SEED COMPANY'S RURAL ONTARIO ROADSIDE NATIVE SEED MIXTURE B145 AND WILL BE PLANTED WITH SCATTERED, NATIVE TREES AND SHRUBS TO PROVIDE COVER FOR DISPERSING AMPHIBIANS.
- HABITAT OF ENDANGERED AND THREATENED SPECIES**
- ALL AGGREGATE OPERATIONS WITHIN THE SITE WILL BE UNDERTAKEN CONSISTENT WITH THE DOCUMENT TITLED 'BES1 MANAGEMENT PRACTICES FOR THE PROTECTION, CREATION AND MAINTENANCE OF BANK SWALLOW HABITAT IN ONTARIO' (OMNRF 2017).
 - ANY NECESSARY REMOVAL OF NATURAL VEGETATION TO SUPPORT PIT OPERATIONS WILL BE COMPLETED OUTSIDE THE PRIMARY BIRD NESTING AND BAT ACTIVITY PERIODS (I.E., TO BE COMPLETED BETWEEN DECEMBER 1 AND MARCH 31).

HYDROGEOLOGICAL REPORT - GROUNDWATER SCIENCE CORP. - MARCH 2026

MONITORING, MITIGATION AND CONTINGENCY PLAN
 WHERE THE MINISTRY OF NATURAL RESOURCES AND FORESTRY WITH THE ASSISTANCE OF THE MINISTRY OF THE ENVIRONMENT CONSERVATION AND PARKS, ACCORDING TO EXISTING WATER WELL INTERFERENCE COMPLAINT PROTOCOLS, HAS DETERMINED THAT THE OPERATION OF THE PIT HAS CAUSED ANY WELL WATER TO BE ADVERSELY AFFECTED, THE LICENSEE SHALL, AT THE LICENSEE'S EXPENSE, EITHER DEEPEN THE WELL OR REPLACE THE WELL TO ENSURE THAT HISTORIC WATER PRODUCTION QUALITY STANDARDS ARE MAINTAINED FOR THAT WELL. IF THIS PIT OPERATION HAS CAUSED A WATER SUPPLY PROBLEM, THE LICENSEE SHALL, AT THEIR EXPENSE, ENSURE A CONTINUOUS SUPPLY OF POTABLE WATER TO THE AFFECTED LANDOWNER.

IN ORDER TO CONFIRM WATER TABLE ELEVATIONS AT THE SITE, THE FOLLOWING MONITORING PROGRAM IS RECOMMENDED:

- WATER LEVEL MEASUREMENTS SHALL BE OBTAINED ON A QUARTERLY (SEASONAL) BASIS AT MW1, MW5, AND MW6, AS ACCESSIBLE.
- THE MONITORING RESULTS WILL BE SUMMARIZED ANNUALLY BY THE OPERATOR AND MADE AVAILABLE TO MNR UPON REQUEST.

OPERATIONS NOTES

GENERAL INFORMATION

THIS PLAN DEPICTS A SCHEMATIC OPERATIONS AND REHABILITATION SEQUENCE FOR THIS PROPERTY BASED ON THE BEST INFORMATION AVAILABLE AT THE TIME OF PREPARATION. PHASES SHOWN ARE SCHEMATIC AND WILL BE OPERATED ACCORDING TO MATERIAL QUALITY, SITE HYDROLOGY AND HYDROGEOLOGY OR MARKET DEMAND. PHASES DO NOT REPRESENT ANY SPECIFIC OR EQUAL TIME PERIOD.

EXTRACTION SHALL FOLLOW THE SEQUENCE SHOWN ON THIS PAGE AND ON THE OPERATIONAL PLAN PHASES B-D (PAGE 3 OF 4). PROGRESSIVE REHABILITATION SHALL BE CARRIED OUT, AS DEPICTED ON THE OPERATIONAL PLAN PHASES B-D (PAGE 3 OF 4) AND THE REHABILITATION PLAN (PAGE 4 OF 4). DEMAND FOR CERTAIN PRODUCTS OR BLENDING OF MATERIALS WILL REQUIRE SOME DEVIATION IN THE EXTRACTION AND REHABILITATION PHASING. ANY DEVIATIONS FROM THE OPERATIONS SEQUENCE SHOWN WILL REQUIRE APPROVAL FROM MNR.

2. SITE PLAN VARIANCES ARE LISTED IN THE SITE PLAN VARIANCE TABLE SHOWN ON THIS PAGE.

EXTRACTION/PROCESSING/HAULING INFORMATION

3. TOTAL AREA TO BE EXTRACTED IS 9.4 HECTARES.

4a) MAXIMUM NUMBER OF TONNES OF AGGREGATE TO BE REMOVED FROM THE SITE IN ANY CALENDAR YEAR IS 100,000 TONNES.

b) EXTRACTION OF SAND AND GRAVEL ABOVE WATER TABLE WILL TAKE PLACE IN ONE BENCH, WITH A MAXIMUM HEIGHT OF 5 METRES AND WILL COMPLY WITH OHS REGULATIONS REGARDING FACE HEIGHTS. EXTRACTION BELOW WATER SHALL BE TO A DEPTH OF 278m ASL. FRONT END LOADERS, EXCAVATORS, AND DRAGLINES WILL BE USED TO EXTRACT MATERIAL AND HAUL TRUCKS OR CONVEYORS WILL CARRY MATERIAL VIA HAUL ROADS TO THE PLANT FOR FURTHER PROCESSING. REFER TO SECTIONS A-A', B-B', AND C-C' ON DRAWING 4 OF 5 FOR FURTHER DETAILS.

c) HAUL ROADS SHALL BE CONSTRUCTED AS REQUIRED.

d) PORTABLE PROCESSING EQUIPMENT, FOR CRUSHING AND SCREENING WILL BE USED ON SITE AND WILL BE LOCATED ON THE PIT FLOOR CLOSE TO THE PIT FACE AT START UP. IN ADDITION TO PROCESSING, SITE ACTIVITIES WILL INCLUDE STRIPPING AND REHABILITATION. OPERATIONAL EQUIPMENT MAY INCLUDE TRUCKS, LOADERS, EXCAVATOR, BACKHOES, DRAGLINES, BULLDOZERS, SCRAPPERS, CONVEYORS, WASH PLANTS, AND OTHER RELATED EQUIPMENT. PROCESSING EQUIPMENT, STACKERS AND PRODUCT STOCKPILES WILL NOT EXCEED ±15 METRES IN HEIGHT AND WILL BE LOCATED IN THE AREAS SHOWN AND/OR CLOSE TO PIT FACES.

e) TEMPORARY STORAGE/OFFICE TRAILERS MAY BE LOCATED ON SITE, 30 m FROM THE LICENCE BOUNDARY.

f) MATERIAL FROM OTHER PROPERTIES MAY BE IMPORTED INTO THE SITE FOR BLENDING, CUSTOM PRODUCTS AND/OR RESALE. THIS MAY INCLUDE AGGREGATE AND/OR PEAT AND TOPSOIL.
 i) EXCESS SOIL SHALL ONLY BE IMPORTED FOR BLENDING, RESALE AND/OR TEMPORARY STORAGE ON SITE IN ACCORDANCE WITH ONTARIO REGULATION 24/07 UNDER THE AGGREGATE RESOURCES ACT.
 ii) LIQUID SOIL, AS DEFINED IN ONTARIO REGULATION 406/19 UNDER THE ENVIRONMENTAL PROTECTION ACT, IS NOT AUTHORIZED FOR IMPORTATION TO THE SITE.
 iii) THERE SHALL BE NO FURTHER IMPORTATION OF EXCESS SOIL FOR BLENDING, RESALE, AND/OR TEMPORARY STORAGE ONCE EXTRACTION ON-SITE HAS BEEN COMPLETED.
 iv) THE TOTAL AMOUNT OF EXCESS SOIL BROUGHT ONTO THE SITE ANNUALLY AND THE TOTAL AMOUNT STORED ON-SITE AT ANY ONE TIME WILL NOT EXCEED 25,000 m³.

5. EQUIPMENT, SCRAP AND MACHINERY ASSOCIATED WITH THE EXTRACTION OPERATIONS WILL BE REMOVED UPON COMPLETION OF EXTRACTION.

HYDROGEOLOGICAL INFORMATION

6. THE MAXIMUM PREDICTED WATER TABLE ELEVATION VARIES ACROSS THE SITE FROM 282.2 TO 283.4 m ABOVE SEA LEVEL (ASL), BASED ON THE HYDROGEOLOGICAL REPORT. REFER TO SECTIONS ON SHEET 4 OF 5.

7. SURFACE DRAINAGE WILL BE DIRECTED TO PONDING AREAS FOR WATER TO INFILTRATE INTO THE GRANULAR MATERIALS ON THE PIT FLOOR. THERE WILL BE NO OFF-SITE DITCHING/ DISCHARGE.

NOISE MITIGATION INFORMATION

8. HOURS OF OPERATION
 SITE PREPARATION AND REHABILITATION: 07:00-19:00 WEEKDAYS, 07:00-NOON SATURDAYS
 EXCAVATION AND PROCESSING: 07:00-19:00 WEEKDAYS, 07:00-NOON SATURDAYS
 SHIPPING: 07:00-19:00 WEEKDAYS, 07:00-NOON SATURDAYS

AIR QUALITY INFORMATION

9. WATER OR CALCIUM CHLORIDE WILL BE APPLIED TO INTERNAL HAUL ROADS AND PROCESSING AREAS AS OFTEN AS REQUIRED TO MITIGATE DUST.

SITE MANAGEMENT INFORMATION

10. MAINTENANCE/ PROTECTION OF VEGETATION INFORMATION
 11. EXISTING VEGETATION WITHIN THE LICENCED AREA SHALL BE MAINTAINED IN A HEALTHY VIGOROUS GROWING CONDITION UNTIL SEQUENTIAL STRIPPING BEGINS OR UNTIL THE REHABILITATION IS COMPLETE. NO TREE SCREENS ARE PROPOSED. ANY VEGETATION PLANTED AS PART OF SITE IMPROVEMENTS OR PROGRESSIVE AND FINAL REHABILITATION WILL ALSO BE MAINTAINED IN A HEALTHY, VIGOROUS GROWING CONDITION.

FENCING & BOUNDARY DEMARCATION INFORMATION

12. BOUNDARIES OF THE AREA TO BE LICENCED THAT ARE PRESENTLY FENCED ARE SHOWN ON DRAWING 1 OF 4 EXISTING FEATURES. UNFENCED BOUNDARIES SHALL BE DEMARCATED WITH HIGHLY VISIBLE MARKER POSTS AT INTER-VISIBLE INTERVALS.

TOPSOIL/SUBSOIL/OVERBURDEN STORAGE INFORMATION

13. TOPSOIL AND OVERBURDEN SHALL BE STRIPPED AND STORED SEPARATELY IN BERMS WHERE SHOWN AND IN THE STOCKPILING AREA AS SHOWN.
 14. BERMS SHALL BE CONSTRUCTED AS SHOWN ON OPS PLAN. BERMS SHALL NOT EXCEED 2.1 m. REFER TO TYPICAL BERM CROSS SECTION ON DRAWING 3 OF 5. ALL BERMS SHALL BE SEEDED (USING GRASS/ LEGUME MIXTURE, SEE REHABILITATION PLAN, NOTE #7) IMMEDIATELY UPON COMPLETION TO MINIMIZE NOISE, DUST AND EROSION. ALL BERMS SHALL BE MAINTAINED.

BERM INFORMATION

15. ON COMPLETION OF THE BERMS, EXCESS ON-SITE OVERBURDEN WILL BE USED TO PROGRESSIVELY BACKFILL AND REHABILITATE THE SITE. TOPSOIL CAN BE TEMPORARILY STOCKPILED ON THE PIT FLOOR.
 16. ALL SCRAP, USED MACHINERY AND STUMPS GENERATED THROUGH THE OPERATIONS WITHIN THIS LICENCE WILL BE REMOVED FROM SITE ON AN ONGOING BASIS. STUMPS/ WOODY MATERIAL MAY BE CHIPPED AND USED FOR SOIL ENHANCEMENT OR SAVED AND USED FOR HABITAT DURING PROGRESSIVE REHABILITATION. TREES WILL BE HARVESTED AND SOLD AS LUMBER OR UTILIZED FOR FIREWOOD AND/ OR THEIR BEST USE. UPON COMPLETION OF EXTRACTION, ALL SCRAP EQUIPMENT AND USED MACHINERY SHALL BE REMOVED.

PETROLELIUM INFORMATION

17. ALL REFUELING SHALL OCCUR IN THE ADJACENT LICENCE 628167.

SITE PLAN VARIANCES

THE FOLLOWING CONDITIONS ILLUSTRATED ON THESE PLANS VARY FROM THE OF THE PROVINCIAL STANDARDS MADE UNDER THE AGGREGATE RESOURCES ACT

ITEM	SECTION
1. SETBACK IS REDUCED TO 0 m ALONG THE SOUTH 300 m OF THE WEST BOUNDARY, PER AGREEMENT WITH ADJACENT LICENSEE.	0.13(1)10
2. STOCKPILING MAY OCCUR WITHIN 30m OF THE WEST BOUNDARY PER AGREEMENT WITH ADJACENT LICENSEE.	0.13(1)13
3. FENCING WILL BE OMITTED FROM THE WEST BOUNDARY PER AGREEMENT WITH ADJACENT LICENSEE, ALONG THE EAST AND SOUTHWEST BOUNDARY, WOODED AND WETLAND CONDITIONS PROHIBIT ACCESS; AND ALONG THE NORTH BOUNDARY PER AGREEMENT WITH ADJACENT LANDOWNER. FENCING AND FIELD ACCESS GATE WILL BE INSTALLED ALONG THE NORTH PROPERTY BOUNDARY.	0.13(3)8
4. A GATE SHALL BE OMITTED AT THE ENTRANCE/EXIT ALONG THE WEST BOUNDARY PER AGREEMENT WITH ADJACENT LICENSEE. ENTRANCE/EXIT MAY BE LOCATED ANYWHERE ALONG THE 0 m SETBACK.	0.13(1)1
5. SOUTH BOUNDARY FENCE SHALL BE OFFSET UP TO 5 m TO PREVENT DAMAGE TO TREES.	0.13(3)8

LEGEND

- BOUNDARY OF LICENCED AREA
- 120m INFORMATION BOUNDARY
- EXISTING LICENCED AREA
- LOT LINE
- UTRCA REGULATION LIMIT

- EXISTING FENCE
- EXISTING 5m ASL CONTOUR LINE
- EXISTING 1m ASL CONTOUR LINE
- EXISTING SPOT ELEVATION
- EXISTING TREE COVER
- EXISTING WETLAND
- EXTRACTION FACE
- BERM
- UNDISTURBED AREA
- AREA STRIPPED OF TOPSOIL AND OVERBURDEN
- BUFFER PLANTING
- HP
- BH/MW
- ENTRANCE/EXIT
- DIRECTION OF EXTRACTION
- DIRECTION OF TOPSOIL AND OVERBURDEN MOVEMENT
- LOCATION OF NOISE RECEPTOR
- EXISTING ELEVATION
- EXTRACTION ELEVATION
- LOCATION OF SECTION
- SILT FENCE
- MARKER POST

NO.	DATE	REVISIONS	OWNER	HW	UWR

Pre Licence Review Site Plan Amendments

Harrington
McAvan Ltd
 6882 14th Avenue
 Markham, Ontario L6B 1A8
 Tel: 905-294-5282 Fax: 905-294-7523
 www.harringtonmcavan.com
 Offices in Markham & Cambridge

Project Name

PATON
AGGREGATES
& SOILS LTD.
TRAFALGAR EXPANSION PIT

LICENCE No:
 LICENCEE SIGNATURE
 PART LOT 17, CONCESSION 2 NTR
 MUNICIPALITY OF THAMES CENTRE (FORMERLY NORTH DORCHESTER), COUNTY OF MIDDLESEX

Scale 1: 2000 North Stamp

Drawing Status FOR LICENCE APPROVAL

Drawn SB Checked RM/BJ Issue Date MAR 2026

Drawing Title OPERATIONAL PLAN PHASE B

Project Number 24-22 Drawing Number 2 OF 4

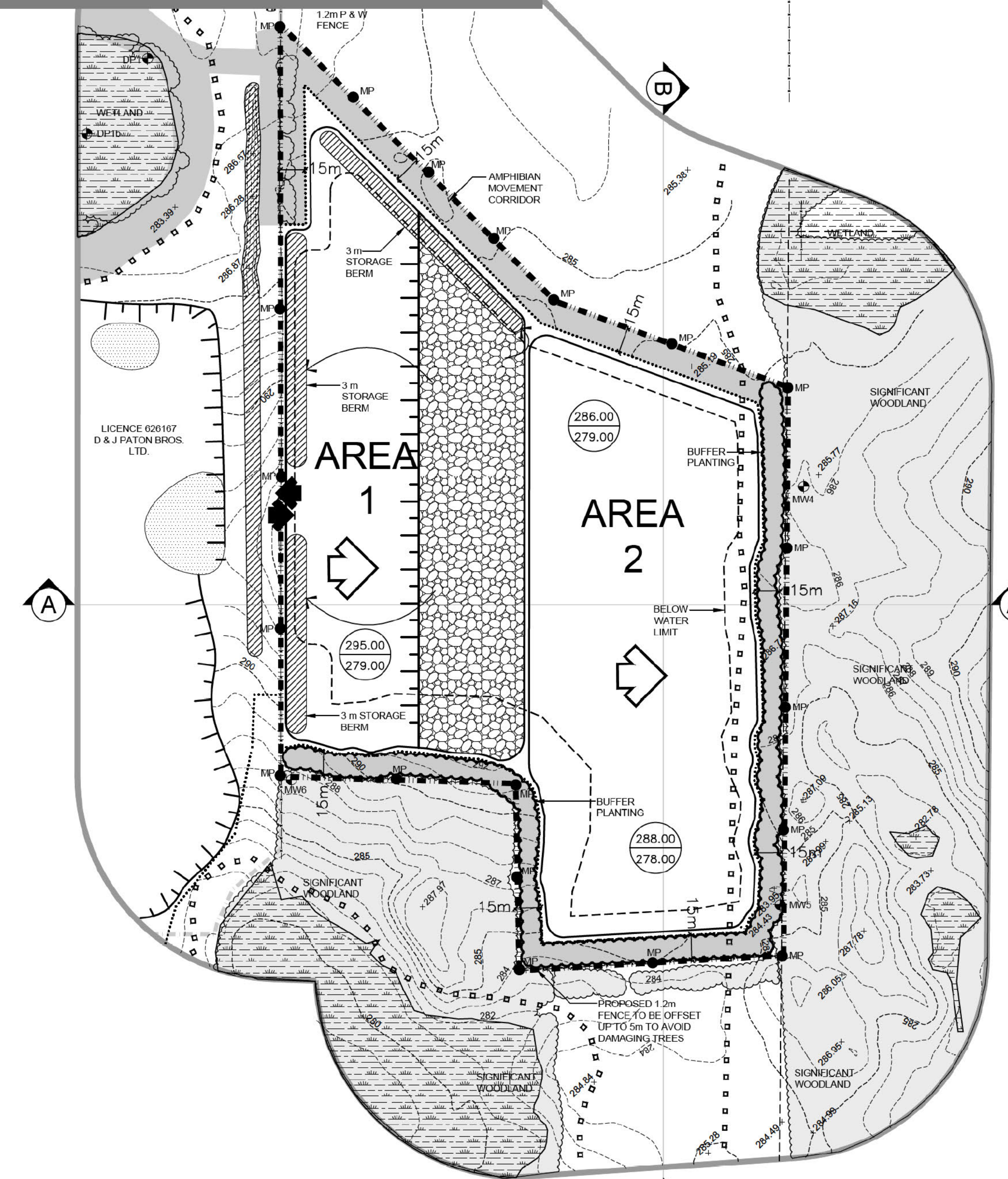

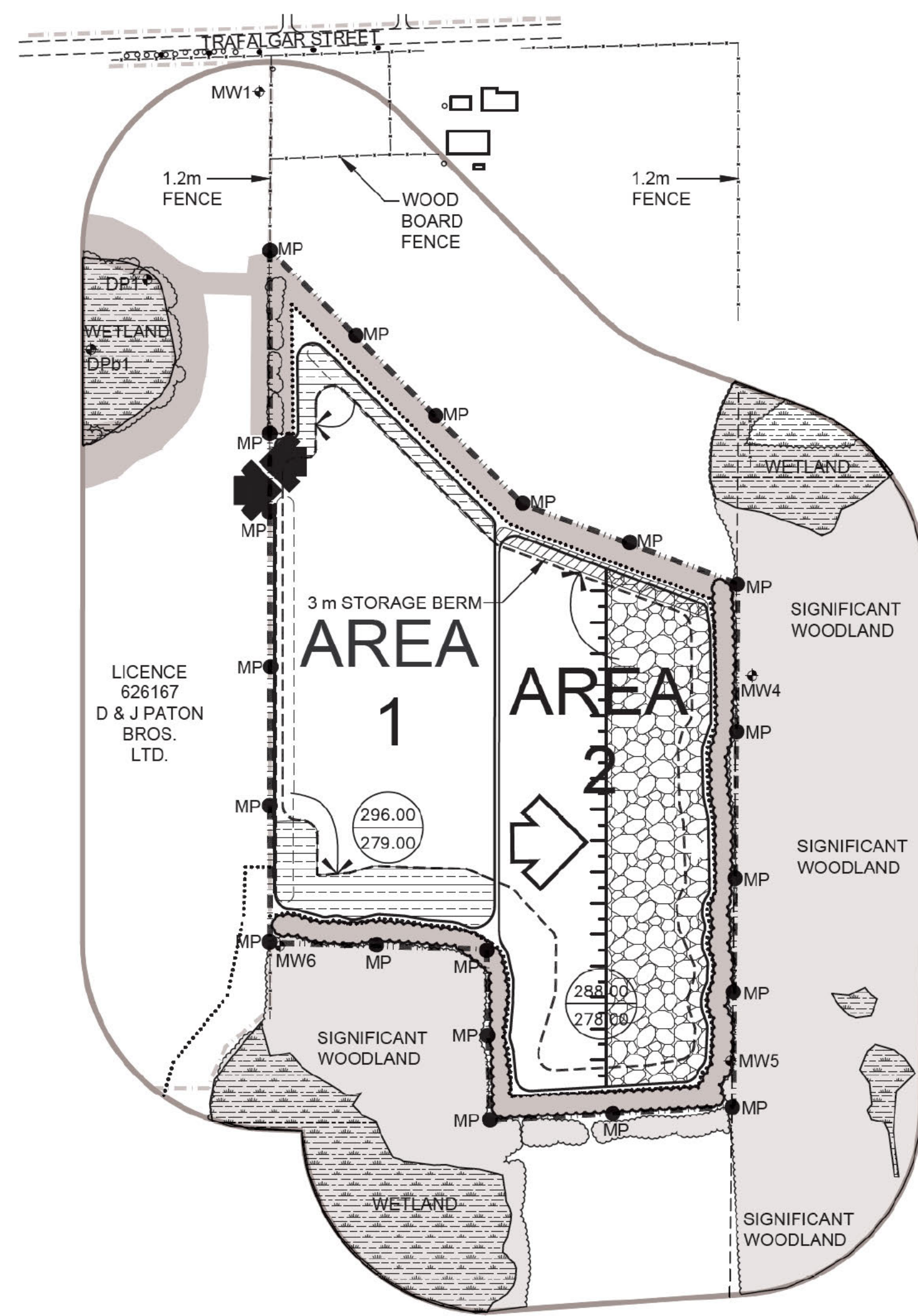

PHASE B
PHASE B NOTES

1. COMPLETE ABOVE WATER EXTRACTION IN AREA 1.
2. PRIOR TO EXTRACTION IN AREA 2, STRIP TOPSOIL AND OVERBURDEN SEPARATELY AND USE TO BEGIN PROGRESSIVE REHABILITATION OF NORTH AND SOUTH SIDE SLOPES IN AREA 1. EXCESS OVERBURDEN AND TOPSOIL MAY BE STORED IN PILES ON THE PIT FLOOR AND STORAGE BERMS AS SHOWN.
3. BEGIN ABOVE WATER EXTRACTION IN AREA 2 IN DIRECTION SHOWN.
4. MAINTAIN ALL VEGETATION IN A HEALTHY, VIGOROUS GROWING CONDITION.

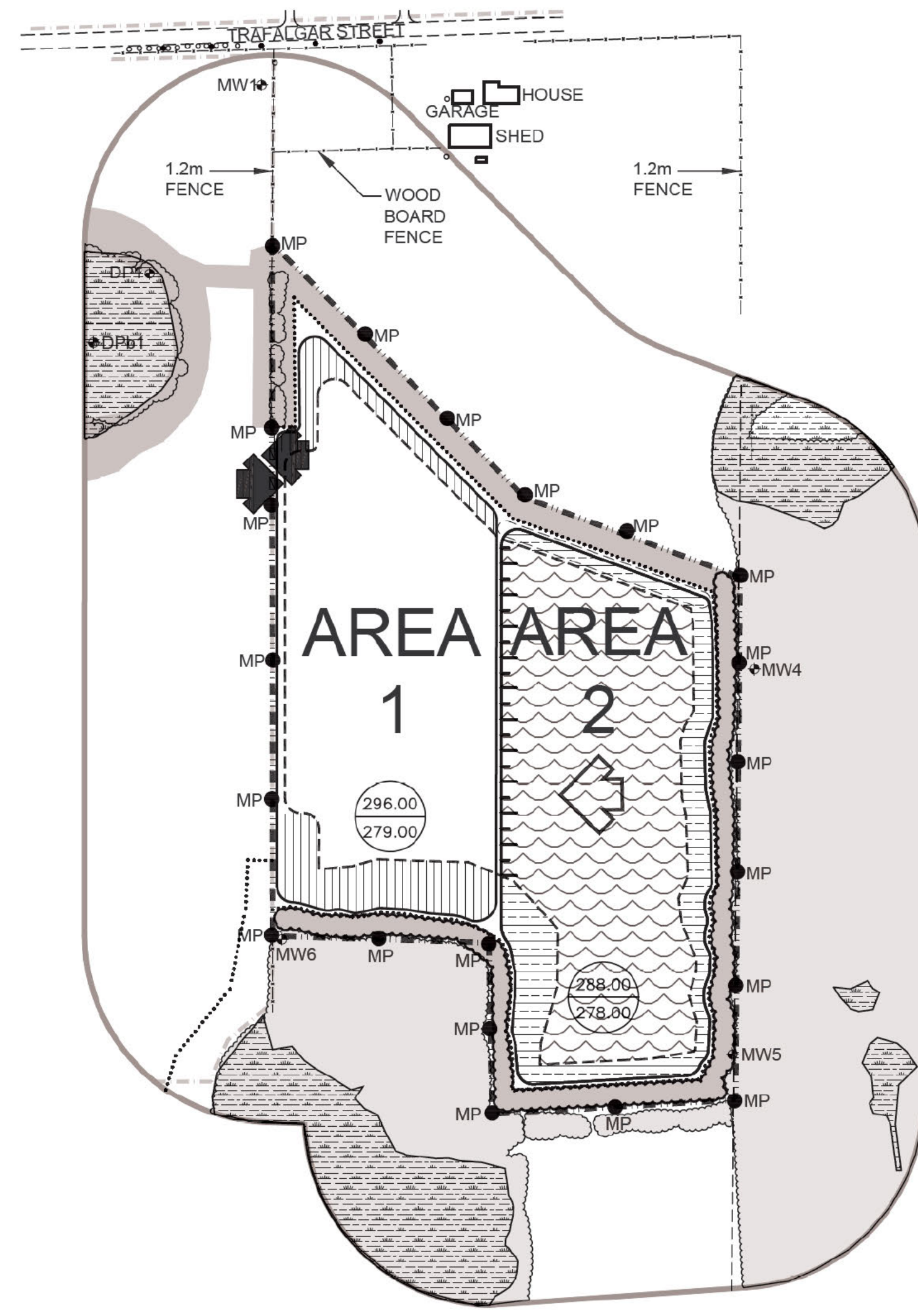

PHASE C
PHASE C NOTES

1. COMPLETE PROGRESSIVE REHABILITATION OF NORTH AND SOUTH SIDE SLOPES IN AREA 1.
2. COMPLETE ABOVE WATER EXTRACTION IN AREA 2.
3. BEGIN BELOW WATER EXTRACTION IN AREA 2 IN DIRECTION SHOWN. MATERIAL EXTRACTED FROM BELOW WATER WILL BE PLACED IN WINDROWS ON THE PIT FLOOR TO DRAIN BEFORE BEING TRANSPORTED FOR PROCESSING. SHIP MATERIAL TO TEMPORARY PLANT SITE (NOT SHOWN, PORTABLE PROCESSING EQUIPMENT TO BE USED).
4. BEGIN PROGRESSIVE REHABILITATION OF SHORELINE IN AREA 2.
5. MAINTAIN ALL VEGETATION IN A HEALTHY, VIGOROUS GROWING CONDITION.

PHASE D (NOT SHOWN)
PHASE D NOTES

1. COMPLETE BELOW WATER EXTRACTION IN AREA 2 AND BEGIN BELOW WATER EXTRACTION IN AREA 1 IN DIRECTION SHOWN. MATERIAL EXTRACTED FROM BELOW WATER WILL BE PLACED IN WINDROWS ON THE PIT FLOOR TO DRAIN BEFORE BEING TRANSPORTED FOR PROCESSING. SHIP MATERIAL TO TEMPORARY PLANT SITE (NOT SHOWN, PORTABLE PROCESSING EQUIPMENT TO BE USED).
2. COMPLETE SHORELINE REHABILITATION IN AREA 2 AND BEGIN PROGRESSIVE REHABILITATION OF SHORELINE IN AREA 1.
3. COMPLETE BELOW WATER EXTRACTION IN AREA 2.
4. COMPLETE SHORELINE REHABILITATION AND REHABILITATION OF ALL REMAINING AREAS USING MATERIALS STORED IN BERMS.
5. SITE IS REHABILITATED TO A POND.

LEGEND

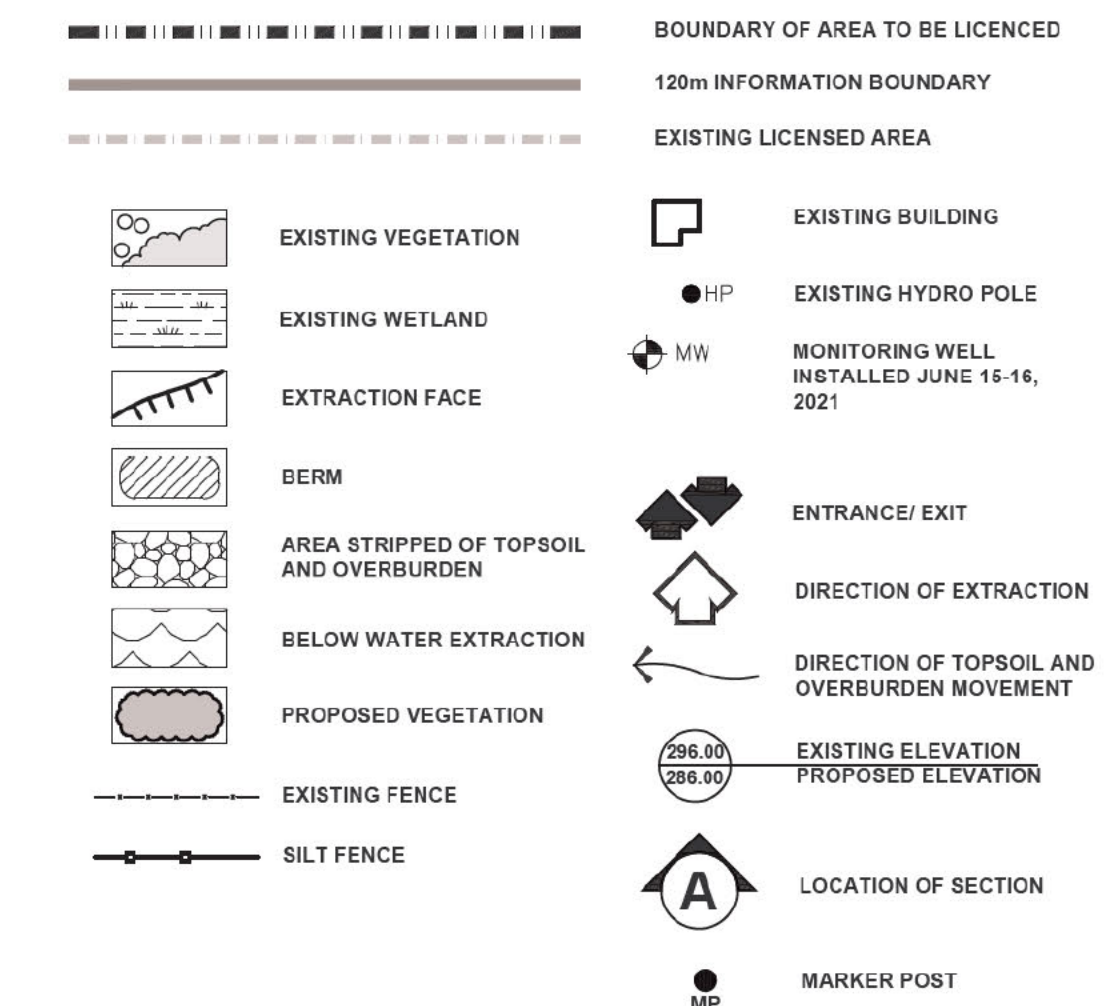

SECTION NOTES
GENERAL INFORMATION

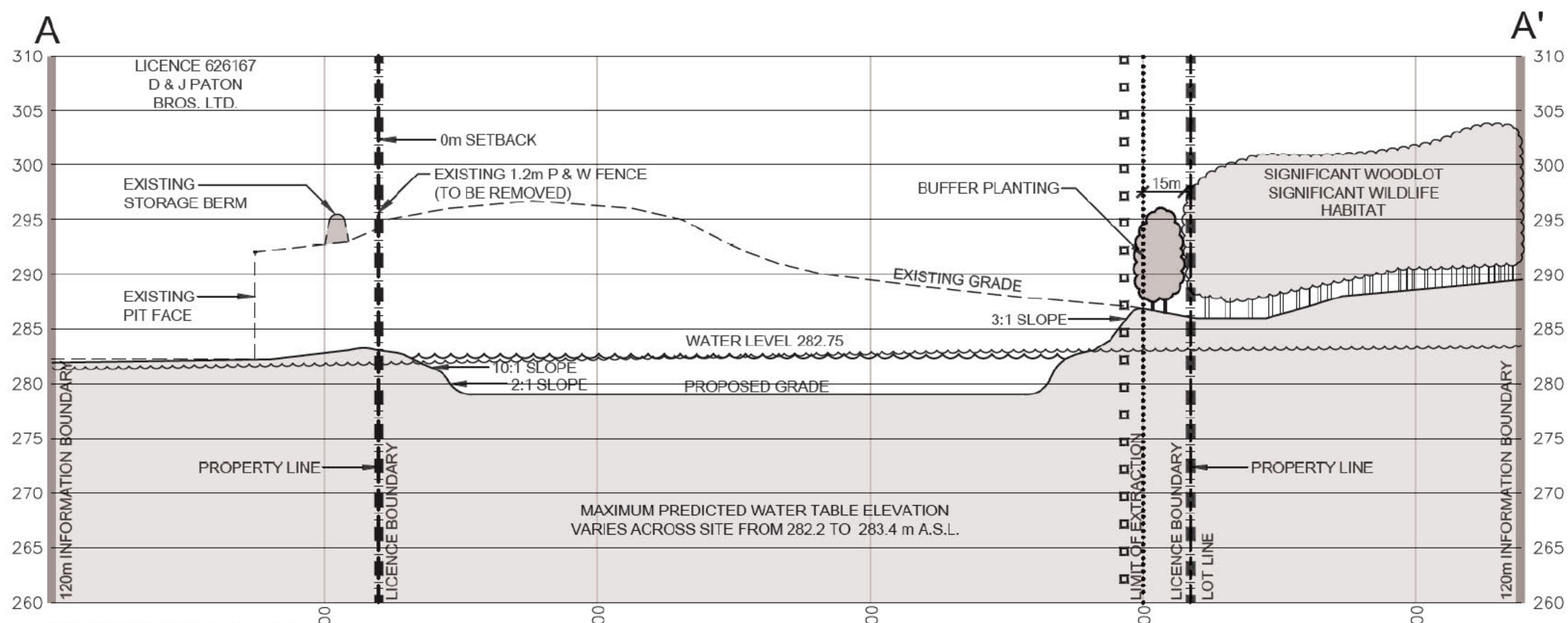
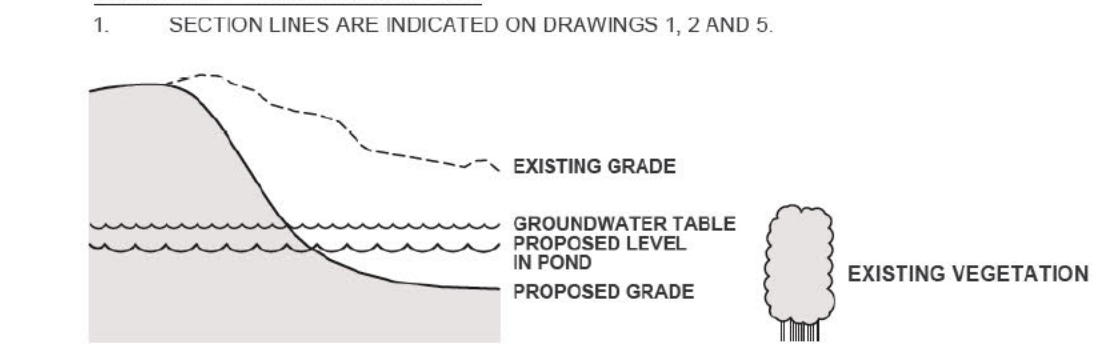

SECTION A-A'
VERTICAL SCALE 1:500
HORIZONTAL SCALE 1:2000

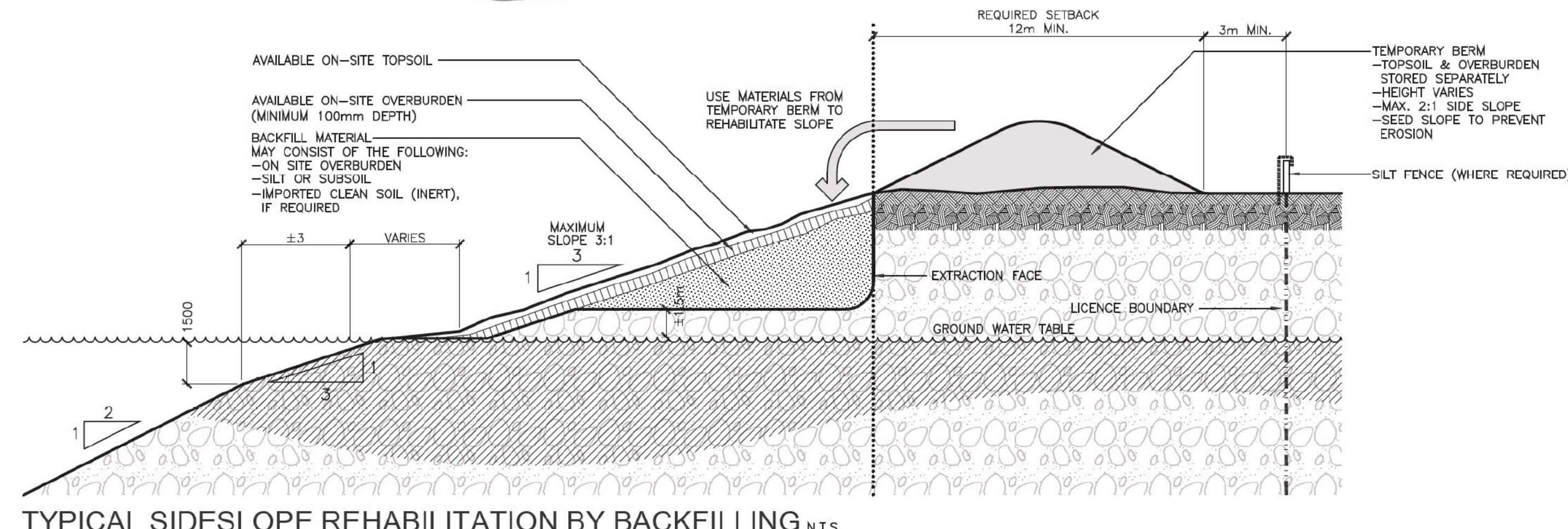

TYPICAL SIDESLOPE REHABILITATION BY BACKFILLING N.T.S.

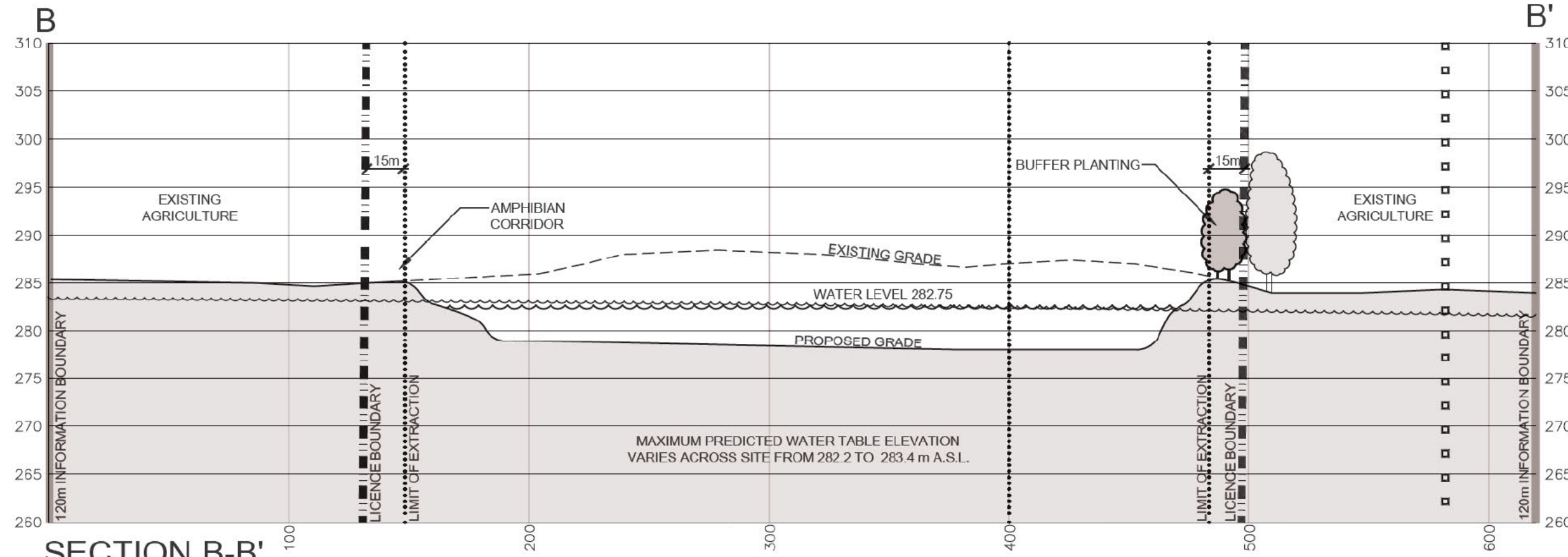

SECTION B-B'
VERTICAL SCALE 1:500
HORIZONTAL SCALE 1:2000

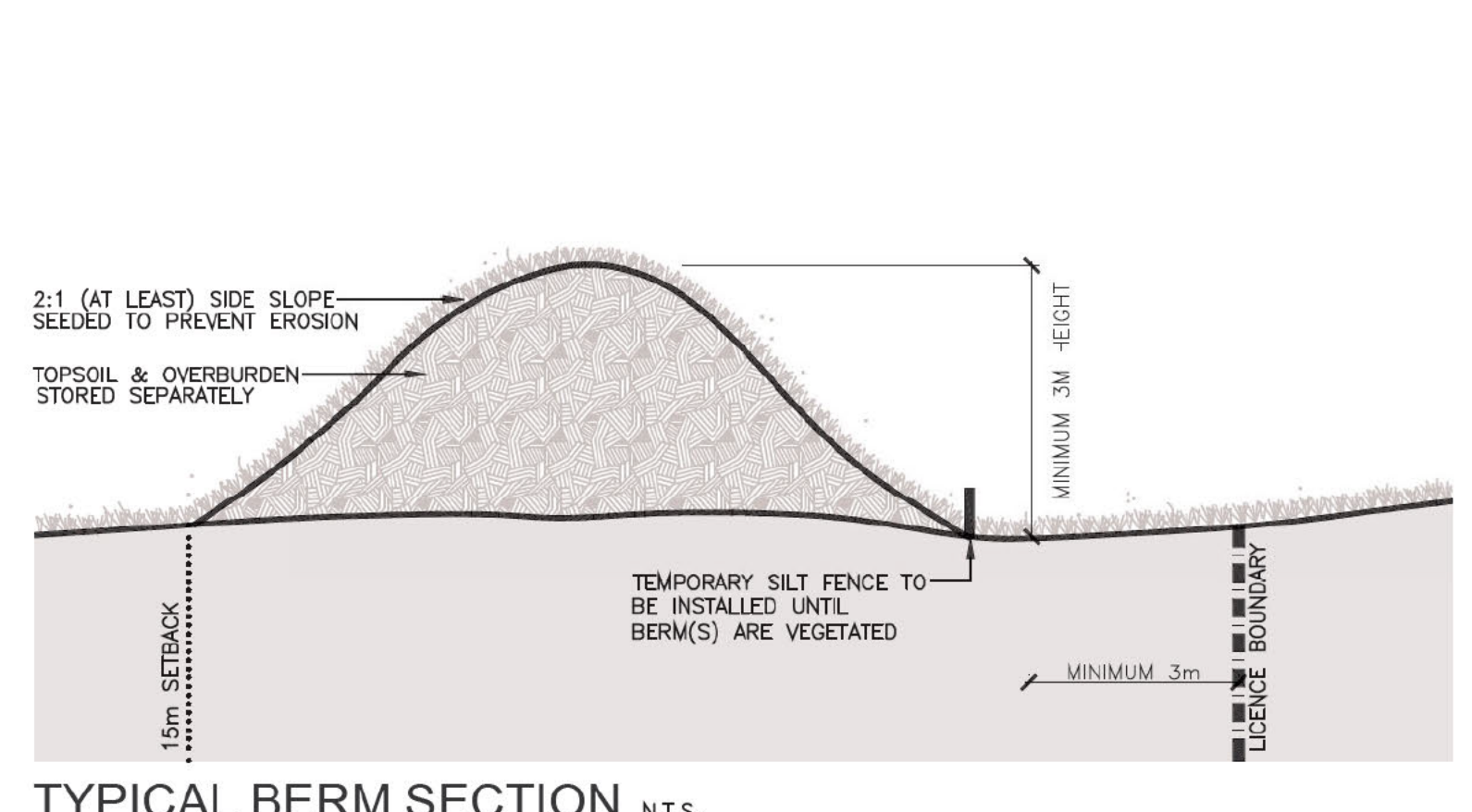

TYPICAL BERM SECTION N.T.S.

NO.	DATE	REVISIONS	OWNER	HW	UNR	NO.	DATE	REVISIONS	OWNER	HW	UNR

Pre Licence Review **Site Plan Amendments**

6882 14th Avenue
Markham, Ontario L3B 1A8
Tel: 905-294-8282 Fax: 905-294-7023
www.harringtonmcavan.com
Offices in Markham & Cambridge

Project Name

PATON AGGREGATES & SOILS LTD.

TRAFALGAR EXPANSION PIT

LICENCE No:
LICENCEE SIGNATURE [REDACTED]
PART LOT 17, CONCESSION 2 NTR
MUNICIPALITY OF THAMES CENTRE (FORMERLY NORTH DORCHESTER), COUNTY OF MIDDLESEX

Scale 1: 2000 North Stamp

Drawing Status: FOR LICENCE APPROVAL

Drawn SB Checked RM/BJ Issue Date MAR 2026

Drawing Title: **OPERATIONAL PLAN PHASE B - D**

Project Number: **24-22**

Drawing Number: **3 OF 4**

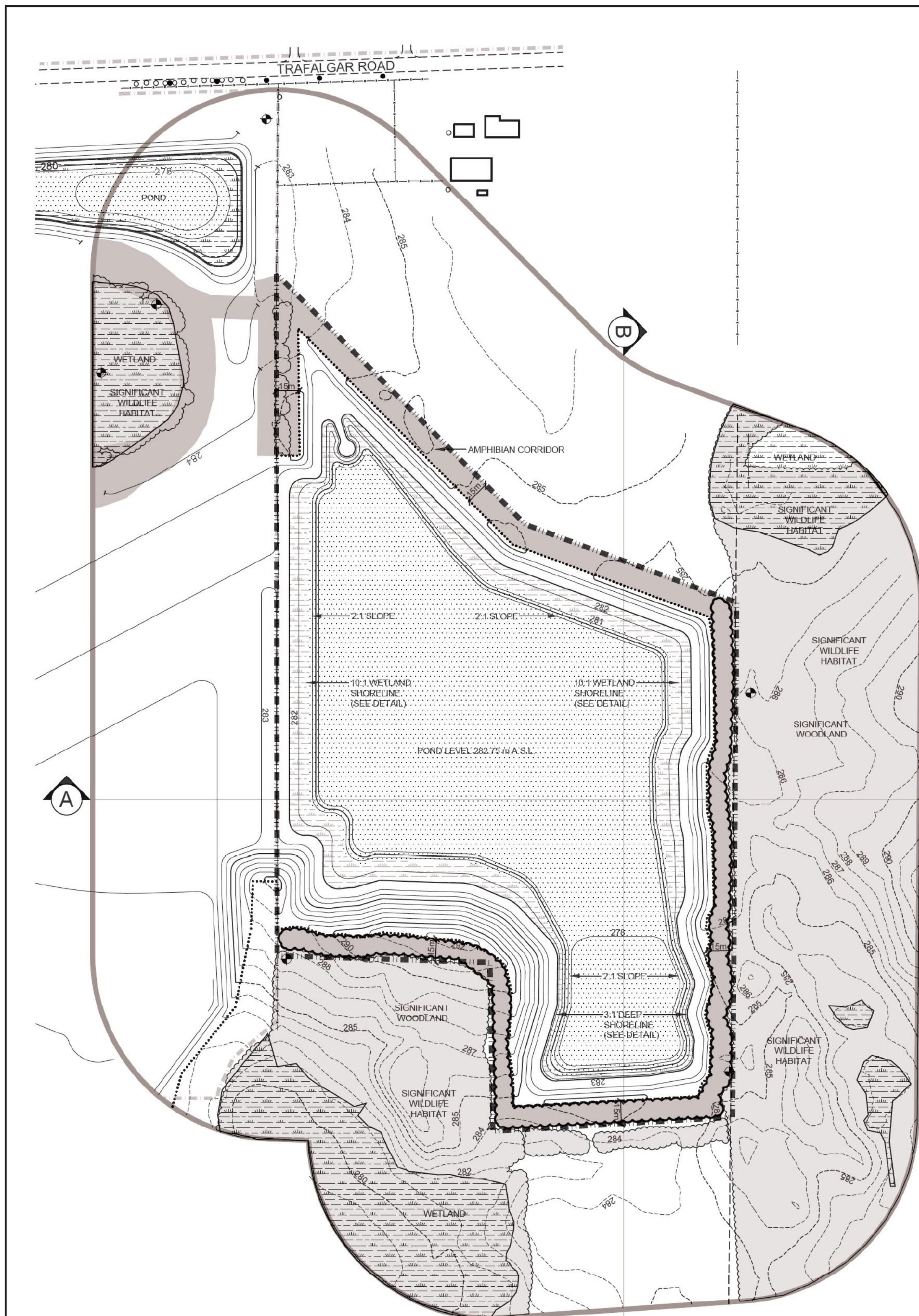

REHABILITATION NOTES

GENERAL INFORMATION
 1. REFER TO SHEET 1 OF 5 FOR EXISTING FEATURES, 2 AND 3 OF 5 FOR SCHEMATIC OPERATIONS, PAGE 4 OF 5 CROSS SECTIONS AND DETAILS, AND PAGE 5 OF 5 REHABILITATION NOTES AND DETAILS.
 2. PROPERTY SHALL BE REHABILITATED TO:

POND	5.7 HA
WETLAND	1.2 HA
MEADOW/WOODLAND	2.5 HA
TOTAL REHABILITATION	9.4 HECTARES

HYDROGEOLOGICAL INFORMATION
 3. IT IS ANTICIPATED THAT THE GROUNDWATER ELEVATION ACROSS THE SITE WILL REMAIN RELATIVELY UNCHANGED AT 282.2 TO 283.4 m A.S.L. (REFER TO HYDROGEOLOGICAL ASSESSMENT)
 4. ALL SURFACE DRAINAGE WILL BE DIRECTED TO THE LOW AREAS REMAINING ON THE PIT FLOOR SO THAT THE WATER CAN INFILTRATE INTO THE SOILS.

SIDESLOPE AND NATURAL AREAS REHABILITATION INFORMATION
GRADING INFORMATION
 5. REHABILITATED SLOPES WITHIN THE LICENCED AREA WILL BE CONSTRUCTED AS SHOWN ON THE CROSS SECTIONS. SLOPES SHALL BE REHABILITATED BY BACKFILLING (MINIMUM 3:1) AND/OR CUT AND FILL METHOD USING ON SITE SOIL AND/OR OVERBURDEN

TOPSOILING INFORMATION
 6. ALL AVAILABLE TOPSOIL ON THE SITE WILL REMAIN AND BE USED FOR REHABILITATION OF THIS SITE.

VEGETATION STABILIZATION INFORMATION
 7. BERMS SHALL BE SEEDED WITH A MIXTURE THAT MAY INCLUDE THE FOLLOWING AT A RATE OF APPROXIMATELY 125KG/HA:
 BUCKWHEAT RED CLOVER WHITE CLOVER
 TALL FESCUE ANNUAL RYE

SIDE SLOPE MEADOW AREAS SHALL BE SEEDED WITH A SUITABLE MIX COMPRISED OF FORBS, HERBS AND GRASS SPECIES, INCLUDING POLLINATOR/BENEFICIAL SPECIES THAT ARE NATIVE TO THE AREA. NO INVASIVE SPECIES SHALL BE INCLUDED IN THE SEED MIX.

OPEN WATER POND REHABILITATION INFORMATION
 8. THE AVERAGE WATER LEVEL IN THE POST-EXTRACTION POND IS ESTIMATED TO BE 282.75 m A.S.L.
 9. THE SHAPE AND GRADING OF THE PROPOSED POND IS BASED ON THE BEST AVAILABLE INFORMATION AT THE TIME OF LICENSING. ACTUAL EXTRACTION WILL FOLLOW THE BELOW WATER DEPOSIT AND REHABILITATION SHALL FOLLOW THE CONCEPT ILLUSTRATED. THE POND SHALL BE NO LARGER THAN 5.7 HA.

WETLAND REHABILITATION INFORMATION
 10. AREAS SHALL BE REHABILITATED TO WETLAND HABITAT AS FOLLOWS:
 • UNDERWATER SLOPES WILL BE FORMED WITH ON-SITE FILL
 • UNDERWATER SLOPES SHALL BE A MAXIMUM OF 2:1

11. RESTORATION OF THE NEARSHORE, SHALLOW WETLAND ZONE AS SHOWN ON THE TYPICAL SHALLOW SHORELINE SECTION, SHEET 5 OF 5, WILL GENERALLY BE ACCOMPLISHED AS FOLLOWS:

- EXTRACTION AND ROUGH GRADING WILL CREATE A NEARSHORE SHORELINE AREA AT A SLOPE OF 10:1
- FINAL SLOPING OF THE SHORELINE TO CREATE PHYSICAL DIVERSITY BY SCALLOPING THE SHORELINE AND ADDING STRUCTURES
- WOODY DEBRIS, BRANCHES, TREE TRUNKS, STUMPS, ETC. CLEARED IN THE EXTRACTION PROCESS WILL BE SALVAGED WHERE POSSIBLE, FOR USE IN SHORELINE RESTORATION/ UNDERWATER HABITAT ENHANCEMENT
- STUMPS, LOGS, BRUSH BUNDLES, ETC. SHALL BE INSTALLED 500m O.C. ALONG THE SHORELINE IN THE SHALLOW ZONE TO CREATE PHYSICAL DIVERSITY
- OVERSIZE ROCKS NOT UTILIZED IN THE AGGREGATE OPERATIONS WILL ALSO BE PLACED IN THE SHALLOW ZONE TO CREATE PHYSICAL DIVERSITY
- THE INITIAL SHORELINE RESTORATION AREA WILL BE SPORADICALLY PLANTED WITH TREES AND SHRUBS SPECIES MAY INCLUDE THE FOLLOWING NATIVE PLANTS:

RED MAPLE	PUSSY WILLOW	SILVER MAPLE	RED OSIER DOGWOOD
STAGHORN SUMAC	SPECKLED ALDER	LARCH	
WHITE CEDAR	CHOKE CHERRY	SMOOTH SERVICEBERRY	
COMMON NINEBARK	GRAY DOGWOOD	COMMON ELDERBERRY	

12. INITIAL SHORELINE WETLAND AREAS SHALL BE PLANTED WITH CLUMPS OF EMERGENT AND SUBMERGENT NATIVE WETLAND PLANTS TO INITIATE COLONIZATION OF THE SITE AS NUTRIENT LEVELS INCREASE TO SUPPORT THEM. NATIVE WETLAND PLANTS SUCH AS:

FLOATING PONDWEED	COONTAIL
BROAD LEAVED ARROWHEAD	PICKERELWEED
COMMON WOOLY BULRUSH	SOFTSTEM BULRUSH
GREEN-FRUITED BURREED	RIVER BULRUSH
BROAD LEAVED ARROWHEAD	DARK GREEN BULRUSH
SWAMP MILKWEED	WATER-LILY

WILL BE PLANTED IN CLUSTERS OF 5 AT APPROPRIATE DEPTHS TO BEGIN THE COLONIZATION.

WOODLAND BUFFER PLANTING INFORMATION
 13. TWO ROWS OF NATIVE TREES (INCLUDING ANY OF THE FOLLOWING NATIVE SPECIES) SHALL BE PLANTED AT 3 m ON CENTRE WITHIN THE 15 m SIGNIFICANT WOODLAND SETBACK

WHITE PINE	EASTERN COTTONWOOD	SUGAR MAPLE
RED PINE	WHITE BIRCH	SILVER MAPLE
EASTERN WHITE CEDAR	BUR OAK	RED MAPLE
WHITE SPRUCE	RED OAK	SLEUPHY ELM
COMMON HACKBERRY	BLACK CHERRY	

IMPORTATION OF EXCESS SOIL INFORMATION

14. EXCESS SOIL, AS DEFINED IN ONTARIO REGULATION 244/97 MAY BE IMPORTED TO THIS SITE TO FACILITATE THE FOLLOWING REHABILITATION:

- CREATION OF 3:1 SLOPES (OR SLOPING RATIO OTHERWISE DESCRIBED ON THE FINAL REHABILITATION PAGE)
- TOP DRESSING TO ESTABLISH VEGETATION
- GENERAL FILL VOLUME AS REQUIRED TO ACHIEVE REHABILITATION GRADE.

b. LIQUID SOIL, AS DEFINED BY ONTARIO REGULATION 406/19 UNDER THE ENVIRONMENTAL PROTECTION ACT, IS NOT AUTHORIZED FOR IMPORTATION INTO THE SITE.

c. THE QUALITY OF EXCESS SOIL IMPORTED TO THE SITE FOR FINAL PLACEMENT MUST BE EQUIVALENT TO OR MORE STRINGENT THAN THE APPLICABLE EXCESS SOIL QUALITY STANDARDS AS DETERMINED IN ACCORDANCE WITH ONTARIO REGULATION 244/97 AS AMENDED FROM TIME TO TIME AND MUST BE CONSISTENT WITH THE SITE CONDITIONS AND THE END USE IDENTIFIED IN THE APPROVED REHABILITATION PLAN.

d. WHERE A QUALIFIED PERSON IS RETAINED OR REQUIRED TO BE RETAINED IN ACCORDANCE WITH ONTARIO REGULATION 244/97, THE QUALITY, STORAGE, AND FINAL PLACEMENT OF EXCESS SOILS SHALL BE DONE ACCORDING TO THE ADVICE OF THE QUALIFIED PERSON.

e. EXCESS SOIL IMPORTED TO FACILITATE REHABILITATION AS DESCRIBED ON THIS SITE PLAN SHALL BE UNDERTAKEN IN ACCORDANCE WITH ONTARIO REGULATION 244/97 UNDER THE AGGREGATE RESOURCES ACT, AS AMENDED FROM TIME TO TIME.

f. THE CUMULATIVE TOTAL AMOUNT OF EXCESS SOIL THAT MAY BE IMPORTED TO THIS SITE FOR REHABILITATION PURPOSES IS 30,000 m³.

LEGEND

	BOUNDARY OF PROPOSED LICENCE
	BOUNDARY OF EXISTING LICENCED AREA
	120m INFORMATION BOUNDARY
	PROPERTY LINES
	REGULATORY SETBACK AND LIMIT OF EXTRACTION
	LOT LINE
	EXISTING BUILDING
	EXISTING HYDRO POLE
	LOCATION OF SECTION
	EXISTING FENCE
	EXISTING 5m ASL CONTOUR LINE
	EXISTING 1m ASL CONTOUR LINE
	EXISTING SPOT ELEVATION in ASL
	PROPOSED 5m CONTOUR LINE
	PROPOSED 1m CONTOUR LINE
	PROPOSED SPOT ELEVATION
	EXISTING VEGETATION
	EXISTING WETLAND
	PROPOSED WETLAND
	PROPOSED OPEN WATER

SITE PLAN VARIANCES

THE FOLLOWING CONDITIONS ILLUSTRATED ON THESE PLANS VARY FROM THE OF THE PROVINCIAL STANDARDS MADE UNDER THE AGGREGATE RESOURCES ACT

ITEM	SECTION
1. IN ORDER TO MAXIMIZE RESOURCE RECOVERY, BELOW WATER GRADES SHALL BE A MAXIMUM 2:1 SLOPE.	0.13(11)19

Pre Licence Review				Site Plan Amendments							
NO.	DATE	REVISIONS	OWNER	HW	MMR	NO.	DATE	REVISIONS	OWNER	HW	MMR

Harrington McAvan Ltd
 6882 14th Avenue
 Markham, Ontario L6B 1A8
 Tel: 905-294-8282 Fax: 905-294-7523
 www.harringtonmcavan.com
 Offices in Markham & Cambridge

Project Name
PATON AGGREGATES & SOILS LTD. TRAFALGAR EXPANSION PIT

LICENCE No:
 LICENCEE SIGNATURE [REDACTED]
 PART LOT 17, CONCESSION 2 NTR
 MUNICIPALITY OF THAMES CENTRE (FORMERLY NORTH DORCHESTER), COUNTY OF MIDDLESEX

Scale 1: 2000	North	Stamp
Drawing Status	FOR LICENCE APPROVAL	Issue Date MAR 2026
Drawn SB	Checked RM/BJ	Project Number 24-22
Drawing Title		Drawing Number
REHABILITATION PLAN		4 OF 4

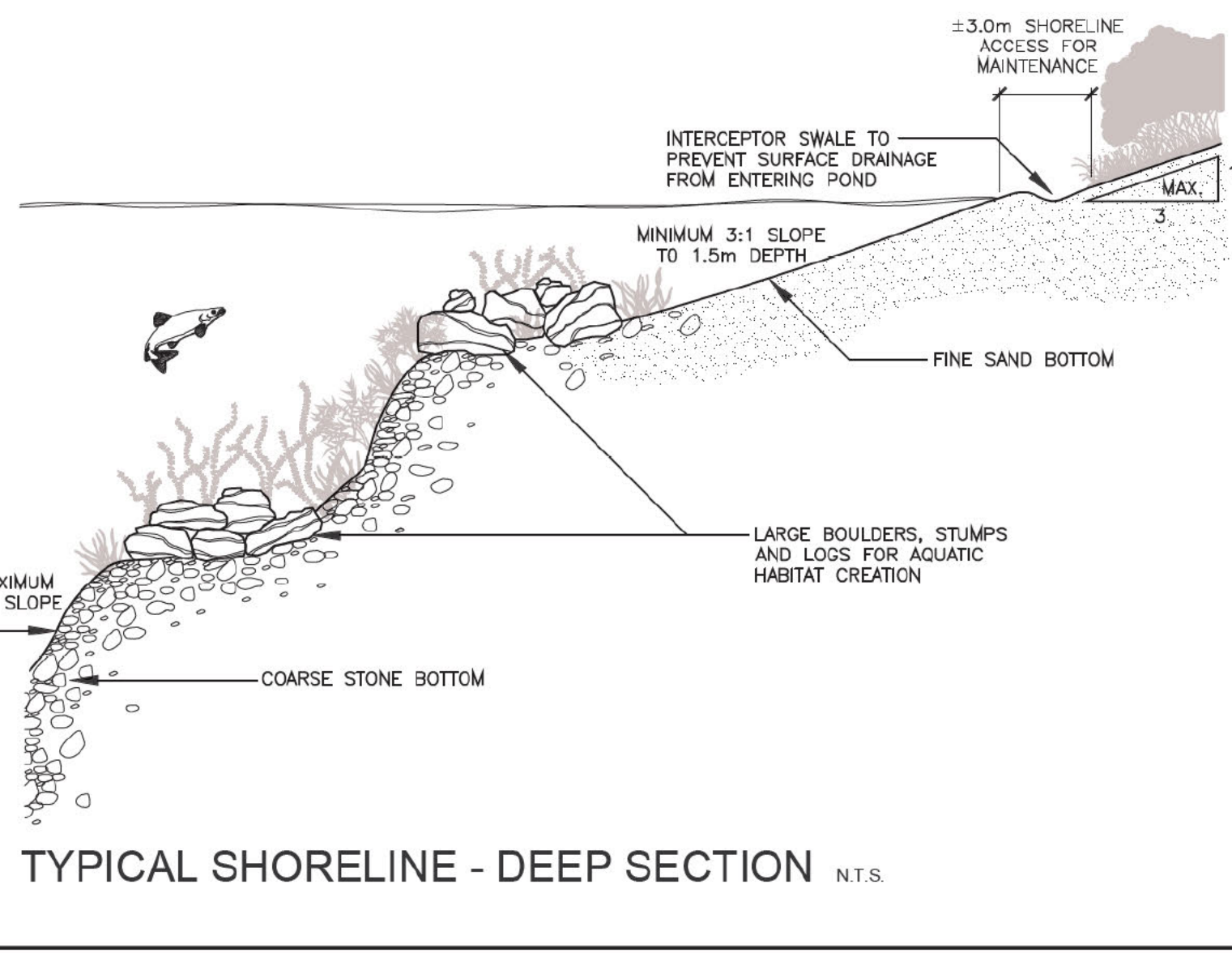
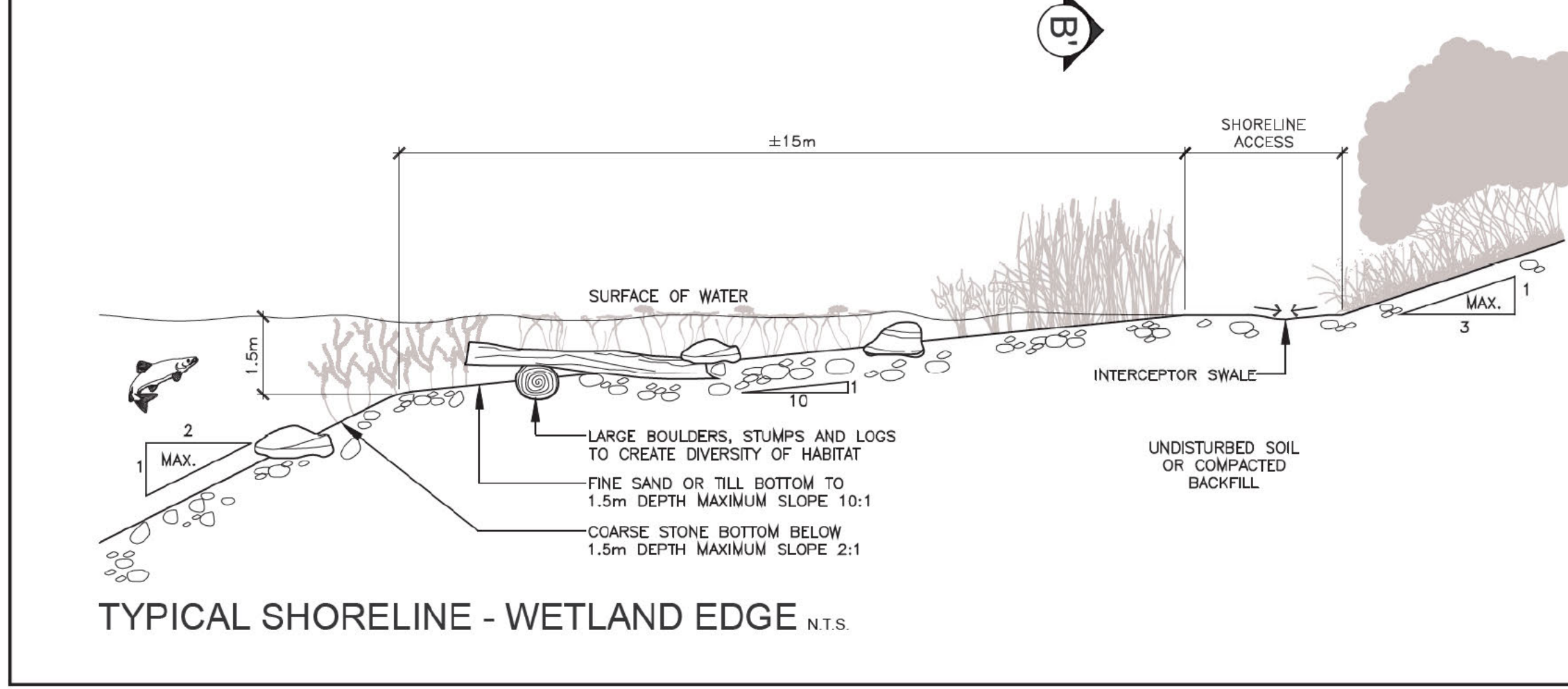

FILE NAME: 24-22/COMP/2422-4.DWG
 PLOT DATE: MARCH 16, 2025